

GARO M INSTALLATION INSTRUCTION

LED outdoor treelight

LED architectural light

WARNING!

Confirm the correct connection method, incorrect connection can lead to improper work, and even damage. If install wrong, it may fall off. Refer to installation instruction for installing.

I. Product introduction:

- The fixture is LED luminaire.
- Surface/Wall installation method.
- ADC12 Die-casting aluminum, High-intensity tempered glass, PMMA optical lens, Reflector, Silicone waterproof sealed
- Isolated space for PCB and diver keeps rapid and stable the heat dissipation.
- Ingress protection is IP66
- Electrical class: Class

II. Observe the following dos and don'ts

1. Install in the IP 65 environment or beneath the IP65.
2. Prohibit punching any position of lamps
3. Please turn off the power and contact the dealer for problems in connection or other abnormal cases.
4. Installed by the qualified electrician holding a certificate.
5. Prohibit operating the lamps beyond the voltage scope as nation stipulated
6. Don't make the external power cable exposed during wiring.

III. Remarks for the cables

When you get the fixture, please check and find the relative version and confirm its Color Temperature, Electrical class, the cable out.

Attention:

- When you get the fixtures is class III, please use a transformation to light.
- When you get the RGB DMX512 fixture, please accurately connect the DMX cables, otherwise, it will influence the regular work.

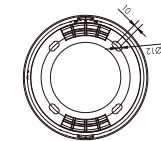
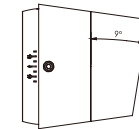
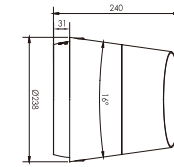

CABLES OUT FOR DIFFERENT COLOR TEMPERATURE AND ELECTRICAL CLASS			
_ VERSION 1		_ VERSION 2	
Single Color _ WW _ CW		_ RGB (DMX512)	
_ Class I	L, N, E	Class III	Power cable: 2pin1 V+ /Red wire, V- /Blue wire
Class III _ DC36V _ DC24V _ DC12V	V+ /Red wire V- /Blue wire	_ DC36V _ DC24V _ DC12V	DMX IN cable: 3pin1 ■DMX+ Red wire ■DMX- Blue wire ■GND Green wire

GARO M INSTALLATION INSTRUCTION

LED outdoor treelight

LED architectural light

IV. Installation Instructions

1. According to step ①②, use screws to fix the bottom on the mountings surface.

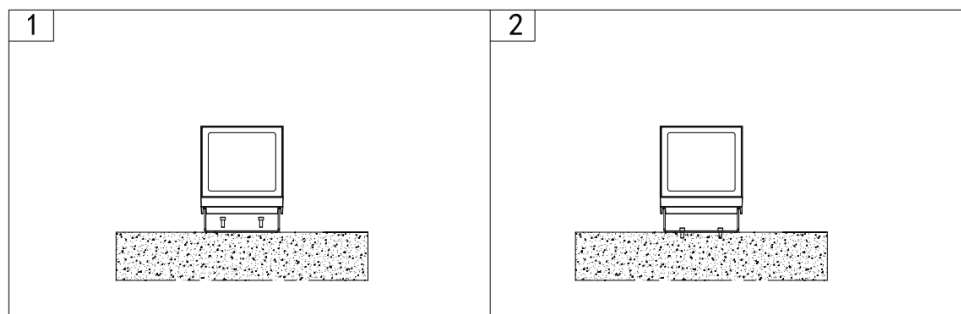

2. According to step ②, adjust the bracket as your project needed.

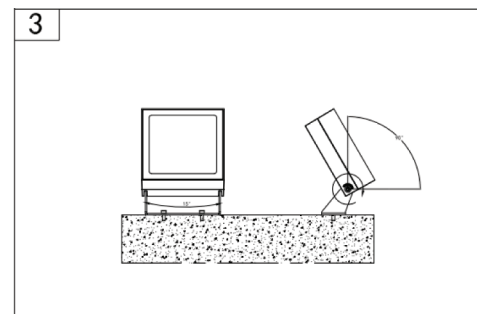

3. **Notes:** The fixture must get reliable connection with the mounting surface, any screws in the lamps should not be arbitrarily loosed. There is no special requirement on the installation direction.

V. Technical specification

Model series	Model NO	Color	Power (W)	Lumen (lm)	Kelvin (K)	CRI	IP	VAC (input) / VDC
GARO M60 (Single color)	GARO M60 827	GR/RAL	35-60W	5400-8400	2700K	CRI80/ CRI90	IP66	220-240VAC/ 24VDC
	GARO M60 830	GR/RAL	35-60W	6000-9120	3000K	CRI80/ CRI90	IP66	220-240VAC/ 24VDC
	GARO M60 840	GR/RAL	35-60W	6600-9960	4000K	CRI80/ CRI90	IP66	220-240VAC/ 24VDC
GARO M60 (Multi color)	GARO M60CCT 82765	GR/RAL	35-60W		2700K-6500K	CRI80/ CRI90	IP66	220-240VAC/ 24VDC
	GARO M60R/G/B	GR/RAL	35-60W		RED/GREEN/BLUE		IP66	220-240VAC/ 24VDC
	GARO M60RGB	GR/RAL	35-60W		RGB		IP66	220-240VAC/ 24VDC
	GARO M60RGBW 8XX	GR/RAL	35-60W		RGBW (W-2700K, 3000K,4000K)	CRI80/ CRI90	IP66	220-240VAC/ 24VDC
Angle	1°/2°/2,5°/3,5°/5°/10°/15°/20°/30°/40°/45°/60°/90°/10x70°/15x60°/25x45°/120x70°/120x50°/150x60°/Custom							
Type of dimming	TUYA, RF, Bluetooth, DMX, 0/1-10V, PWM, TRIAC, SMART, Casambi, Zigbee, DALI, ND, Custom							
Glare protection	Round-meshed grill, Honeycomb glass, Honeycomb grill, Anti-glare shield, Custom							

VI. Customed made by LAMP I A.

VII. LAMP I A s.r.o.

Chmelniky 38,
040 16 Kosice,
Slovak republic

Mobile: + 421 905 549 345

E-mail: lampia@lampia.com

Website: www.lampiatech.com

VIII. LAMP I A has the right to the interpretation of the installation instructions.